

## The Land Between the Lakes Heritage Geocache Challenge 2025 Grocery Stores in LBL

In each geocache box, you should find a sign in sheet, date logbook and 150 aluminum tree tags. We have stamped each tag with numbering specific to that cache location. Collect 1 tree tag per geocache from each of the 7 locations.

- Bring your 7 different tree tags to the Golden Pond Visitor Center.
- Exchange them for a special Challenge Coin created just for this event.
- For extra bragging rights, each Challenge Coin is individually numbered from 1-150.
- Once participants have redeemed all tree tags and collected all Challenge Coins, this years geocache challenge ends.
- After closing the challenge, we collect the boxes to prepare for next years event.

Contact Chris Thornock with any suggestions and comments 270-924-2015 or christopher.thornock@usda.gov



### GEOCACHING

Congratulations, you've found it! (Intentionally or not)

It's part of a worldwide game loved by GPS (Global Positioning System) users who are on the internet. It's like a scavenger hunt—its called geocaching. A GPS user hides a "treasure" (this container) and publishes the exact coordinates so other GPS users can go on a "treasure hunt" to find it.

**IF YOU FOUND THIS CONTAINER BY ACCIDENT**  
Great! You can join us! We only ask:

- Please don't move or vandalize the container. The real fun is just finding it and recording the visit.
- Go ahead and take something if you like. But also leave something too.

[www.geocaching.com](http://www.geocaching.com)

Please respect and protect our local heritage by leaving all the cultural material in its current location. Do not remove or disturb the artifacts.



## A Dill Family Legacy

This is where the legacy of the Dill general stores first began, with JD "Papa" Dill at his Pine Bluff store. You are standing on the ridge above the location where JD Dills store once stood. Just behind the tree line along the shore is a concrete slab and upturned steps, which may have been his store house.

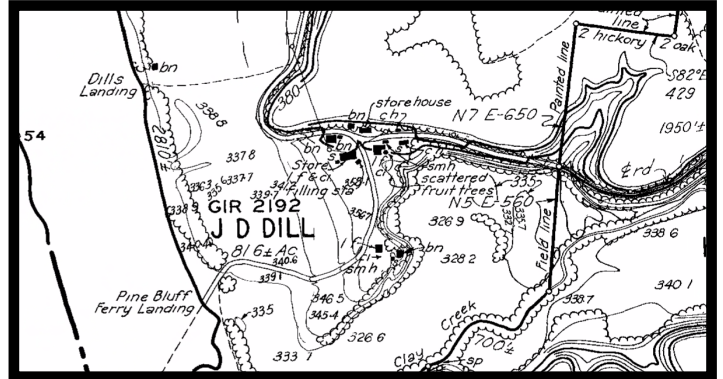

**Tract map of John Daniel Dill's Store, 1930.**

If you look out toward the lake now, maybe you can imagine how it would have looked when it was a river. To the north just around the bend was Dill's landing where barges of goods and supplies would dock and resupply residents of Between the Rivers with the things they needed to survive. To the south would have been the Pine Bluff Ferry which provided transportation to and from the world outside the BTR. Notice the store is located right off the main road to the ferry.

## A Business of Brothers

One of the most intriguing aspects of the culture of the Between the Rivers communities, is that they really were family. Tracing the lineage of renown businesses reveals how these individuals earned their reputation due to their roots in the community.



**Joe's store in Model**

another son, Lewis who started as a huckster working from his dad's store, but soon opened his own store called Dutch's. These 2 stores were only a few miles apart but they served different communities, illustrating the need for general stores especially in areas like the BTR where travel was never easy.



**Lewis's store in Tharpe**

## Joe B. Dill



**Joe Dill's store, a place of community**

Joe and his wife Ruth, were the acknowledged business and social leaders in the Model Community. Many people would come to their store to not only socialize but they also used the telephone, which was a big deal back then. The Dills were also more than willing

to swap home products for staples and canned goods. Like Lewis, Joe began humbly as a huckster peddling eggs and produce. During Joe's 32 years owning and operating the store in Model, he made investments in timber, farm land, theater, real-estate, and a railroad salvage store in Calvert city.

As a result of these investments, when TVA forced the Model community to relocate, Joe was able to open the largest shopping center in Dover TN, for that time. To this day Joe Dill is known as a dedicated business leader of the BTR.



**Joe Dill's store in Dover TN**

## Lewis "Dutch" Dill



**From Left: Ronetta & Gene Crutcher, Lewis & Hazel Dill**

Lewis was given the nickname, Dutch, by his family when he was a kid. As a huckster working for JD "Papa" Dill, Dutch worked the routes through the Tharpe, Tip Top, Blue Springs, and Fort Henry communities. It is possible that this led him to the idea that Tharpe needed its own general store.

In 1940, Lewis and his wife Hazel and their daughter Ronetta moved to Tharpe and opened Dutch's. Ronetta recalls that their home was a beautiful farm, with a variety of animals such as cows, hogs, goats, chickens, ducks, and turkeys. The store was right next to their home, so Ronetta has many fond memories of playing with all the kids who came to the store. Back then people didn't just come to the store for food or supplies, they came to visit, socialize, share stories about the good ole days, and stay in tune with the current events. It was a unique and special time that will hopefully live on in the memories of all those who witnessed it and were told about it.

## A Full Circle Family

In 1954, Lewis passed away, just 2 years after Ronetta married Gene Crutcher. However, Hazel, Ronetta, and Gene maintained the family farm and the business there in the Tharpe community. Shortly after that, TVA took over the property in 1968 and the family was forced to move.



**Gene & Ronetta Crutcher**

But that didn't stop the family legacy! Ronetta and Gene opened, "Crutcher's" Grocery just 6 miles from their old homeplace. The store was located at the intersection of Pumpkin Ridge and Hickman Creek Roads. Today it is a consignment shop off the trace just south of the LBL boundary.

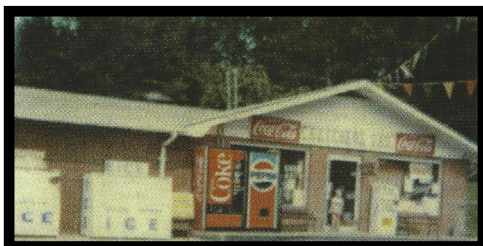

**Crutcher Grocery**

## A Lineage of Crutcher Stores?

To add another layer to the complex interconnections of BTR families and their heritage of trades, there is a story, from "A Country Boy" by Clyde Lyon, about a peddler who stayed the night at the home of Mr. Tom Crutcher. How or whether Tom is related to Gene's family is unknown. However, the story represents the value of and the trust people placed in hucksters and peddlers.

The truncated story: Mr. Crutcher had the misfortune of having cancer on his lip. He had gone to doctors in Dover and Murray, but none of the treatments worked. The peddler noticed the visibly painful affliction and told Mr. Crutcher he may be able to cure it, but it would be terribly painful for 24 hours. Tom agreed to the treatment, which consisted of various plants, roots, and leaves that he gathered in the woods nearby. Once it had thickened to a dark brown liquid, he applied a portion of it to a cloth and affixed it to Mr. Crutcher's lip with string. Tom did indeed suffer intensely;



**Buster and Tince Crutcher's Grocery Store**

ly; his son Buster recalls he was up all night in pain. But his father never relented and low and behold when he removed the cloth, the cancer came with it. It was the size of a marble, but the cancer never returned.